

KTM 2-STROKE 2008 200/250/300 XC/XC-W

INSTALL STATOR AND REGULATOR/RECTIFIER:

For use only with KTM stock stator:
(PN:55139004000) STATOR KOKUSAN

For use with stock flywheel.

- Step 1) Remove seat and fuel tank from bike.
- Step 2) Remove stock stator and flywheel from bike.
- Step 3) Disconnect fuse if applicable (next to battery.)
- Step 4) Release red/white and black/red terminals from clear connector on stock stator with a paper clip. Do not release red or green wires.

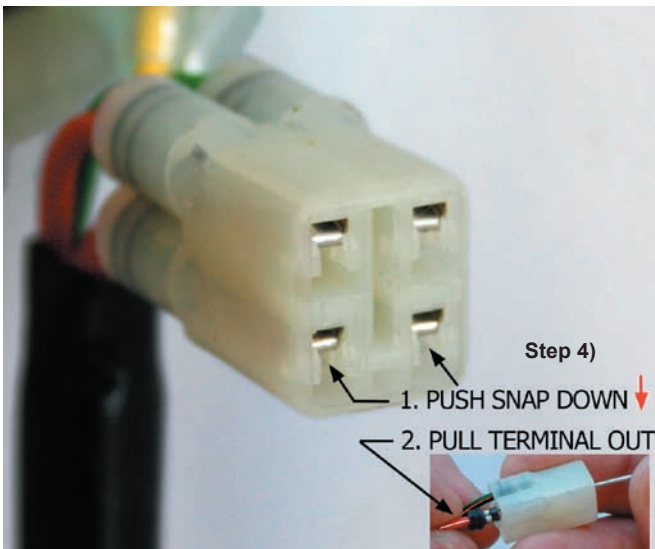

- Step 5) Cut connectors from yellow and white wires.
- Step 6) Cut red/white and black/red wires (from step 4) just below terminals. Do not cut red or green wires.

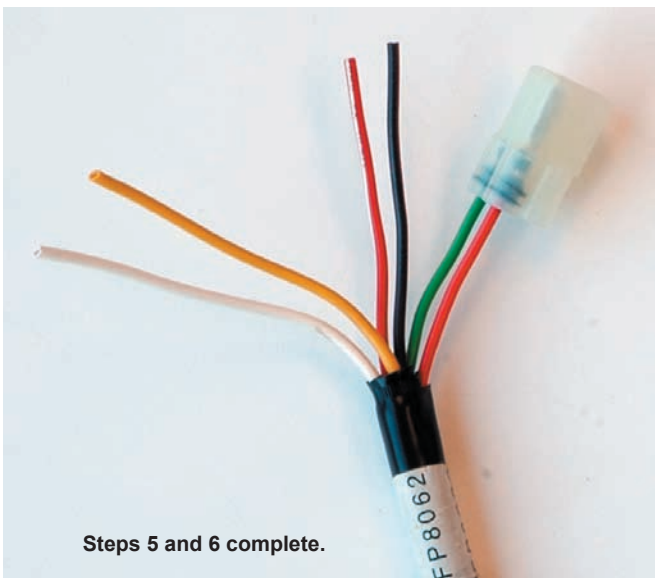

- Step 7) Remove cut stock stator wires from black casing, as shown. Discard stock stator.

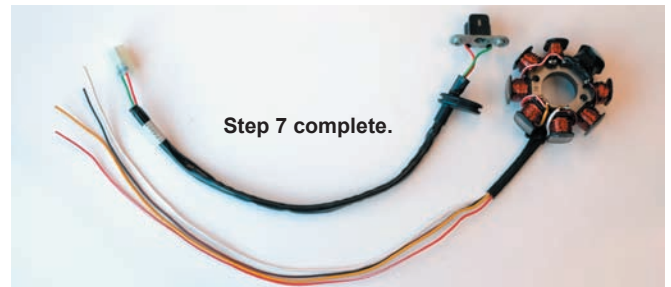
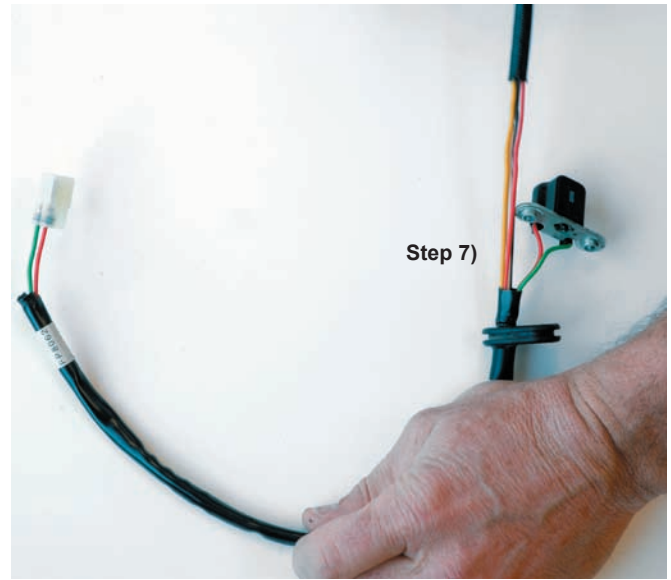

- Step 8) Insert red, then white wires from Trail Tech stator into stock stator black wire casing one at a time. Use alcohol if necessary. Slide black bushing out of the way if the wires bind near bushing.



Step 9) Slide one clear wire cover from the stock stator onto each of the new yellow wires. Crimp the provided Trail Tech spade connectors onto the two yellow wires as shown.

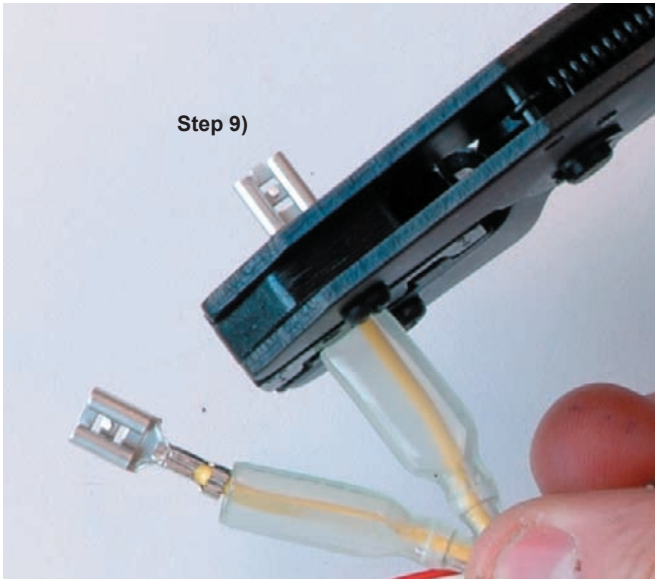

Step 10) Snap the red and white wire terminals from the Trail Tech stator into the stock 4-pin connector.

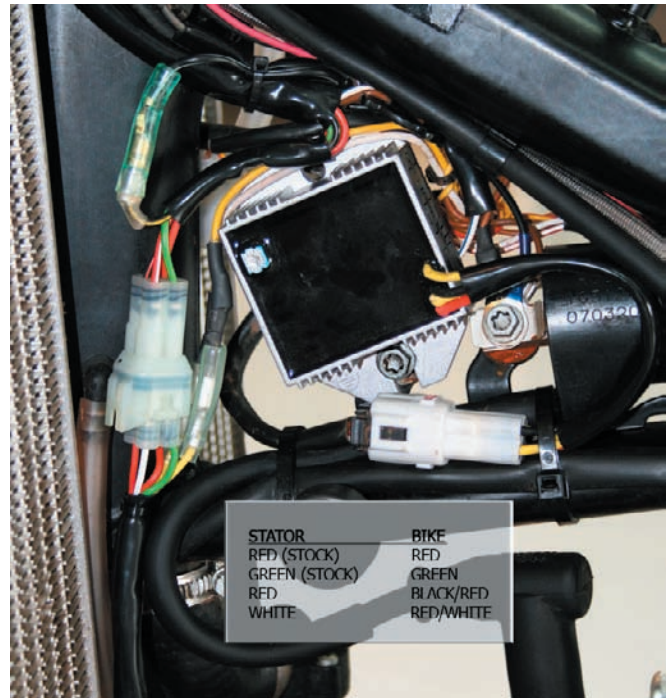
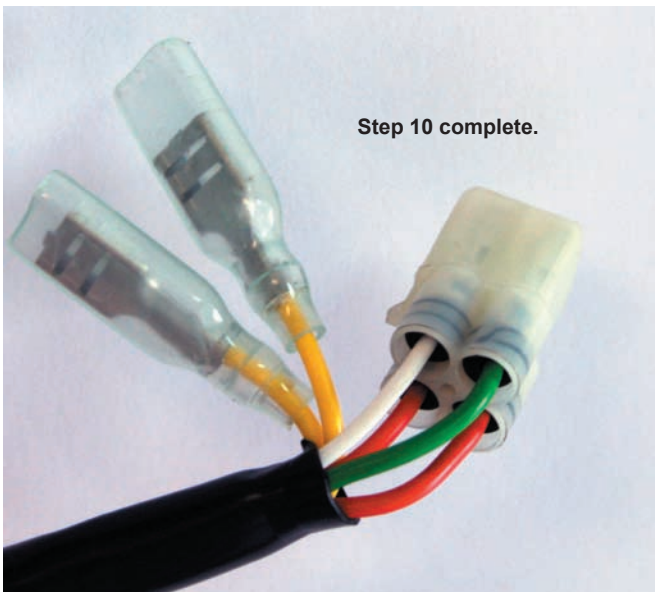

Step 11) Complete the installation. Install the Trail Tech stator assembly. Mount the Trail Tech regulator/rectifier and plug it in. Plug the connectors from the stator into the stock wire harness. Reconnect yellow stator wires to stock location. Yellow to yellow, white to yellow.